

SAMPLE PROJECT 2

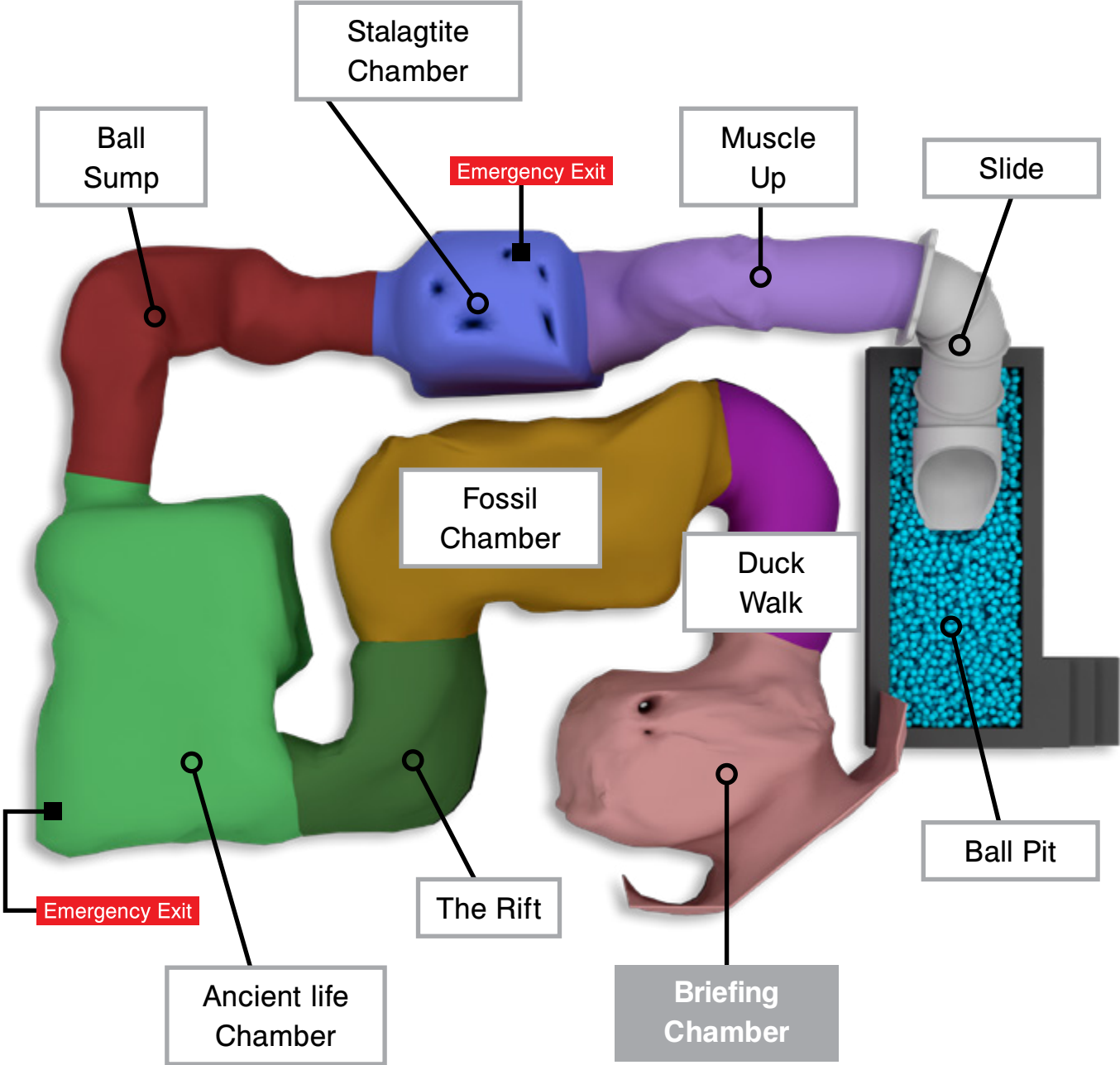

Components

- Ventilation system
- LED lighting
- CCTV
- Sound system
- Emergency exits
- Gear (helmets, knee pads, torches)
- Ball sump
- Rubber floor

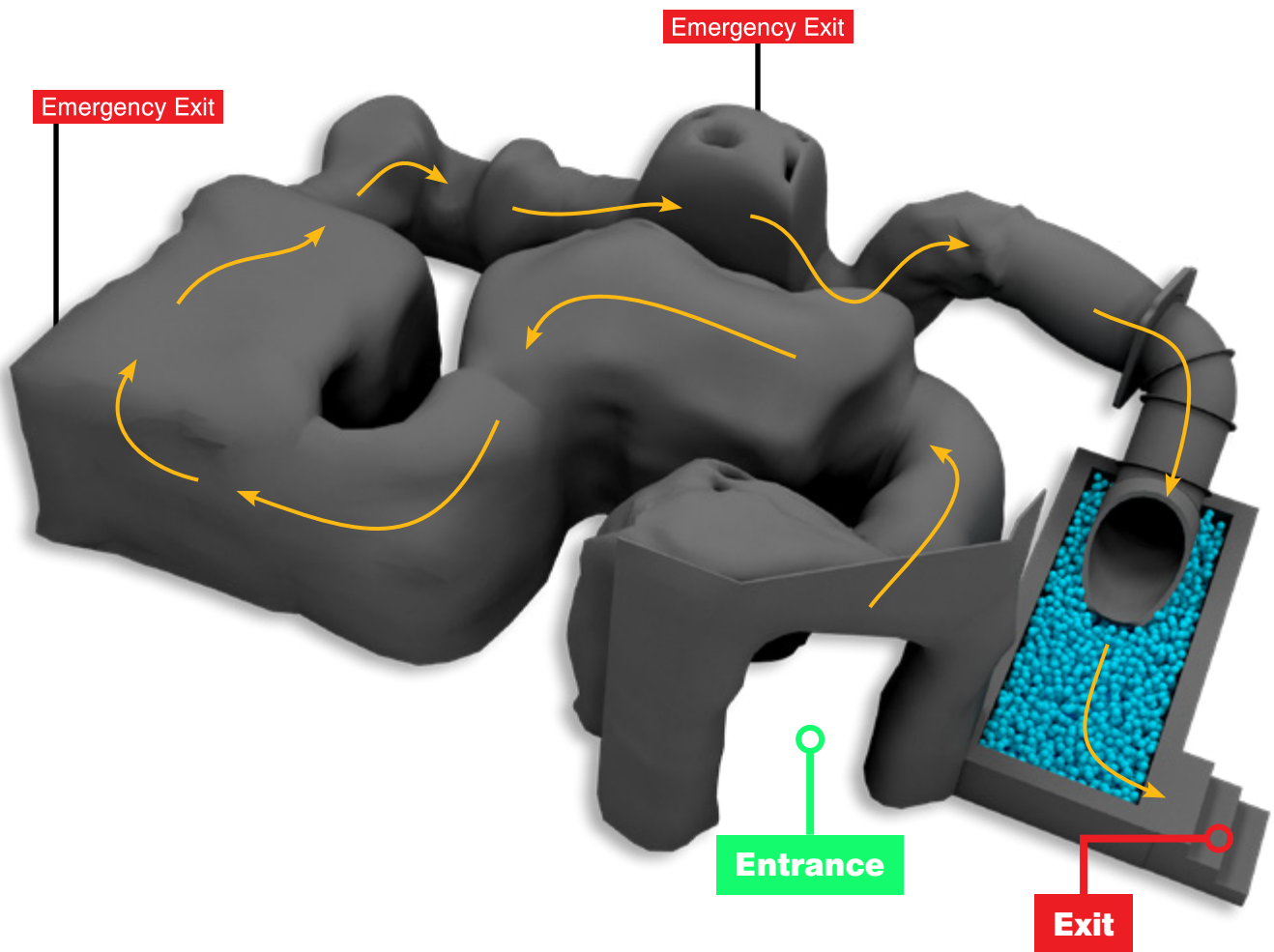

Momentum Capacity	14 people	
Footprint	112 m ²	1,205.5 ft ²
Height	3 m	9.8 ft
Operational Length	30 m	98.4 ft
Route	1	
Min. Operators Required	1	
GRP	200 m ²	2,152.7 ft ²