

SAMPLE PROJECT 5

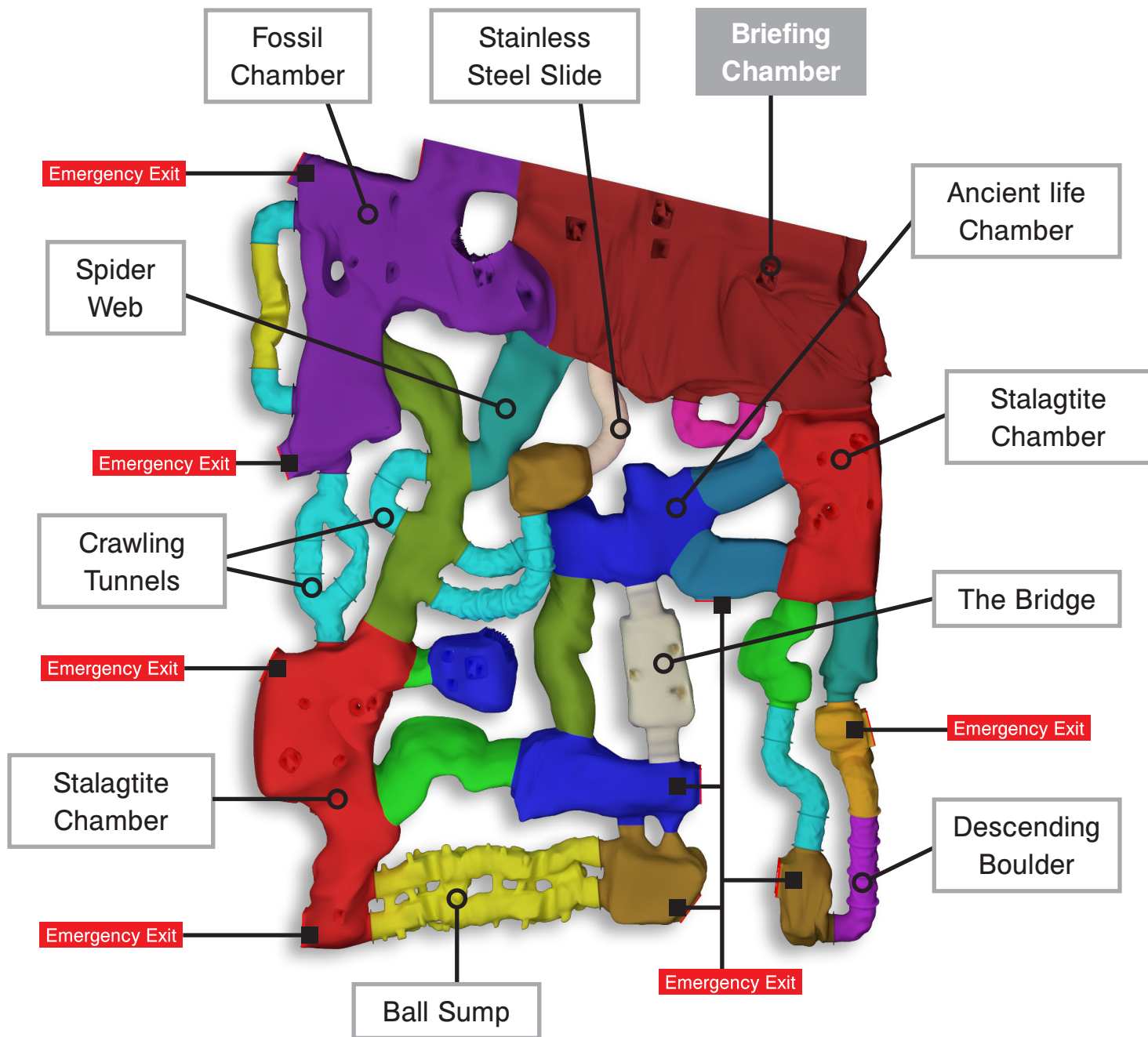

Components

- Ventilation system
- LED lighting
- CCTV
- Sound system
- Gamifier
- Emergency exits
- Gear (helmets, knee pads, torches)
- Ball sump
- Rubber floor
- Spider Web
- 10 rotating rocks
- Lava Stripes
- Obstacles in tunnels
- Stainless Steel Slide
- Muscle Up

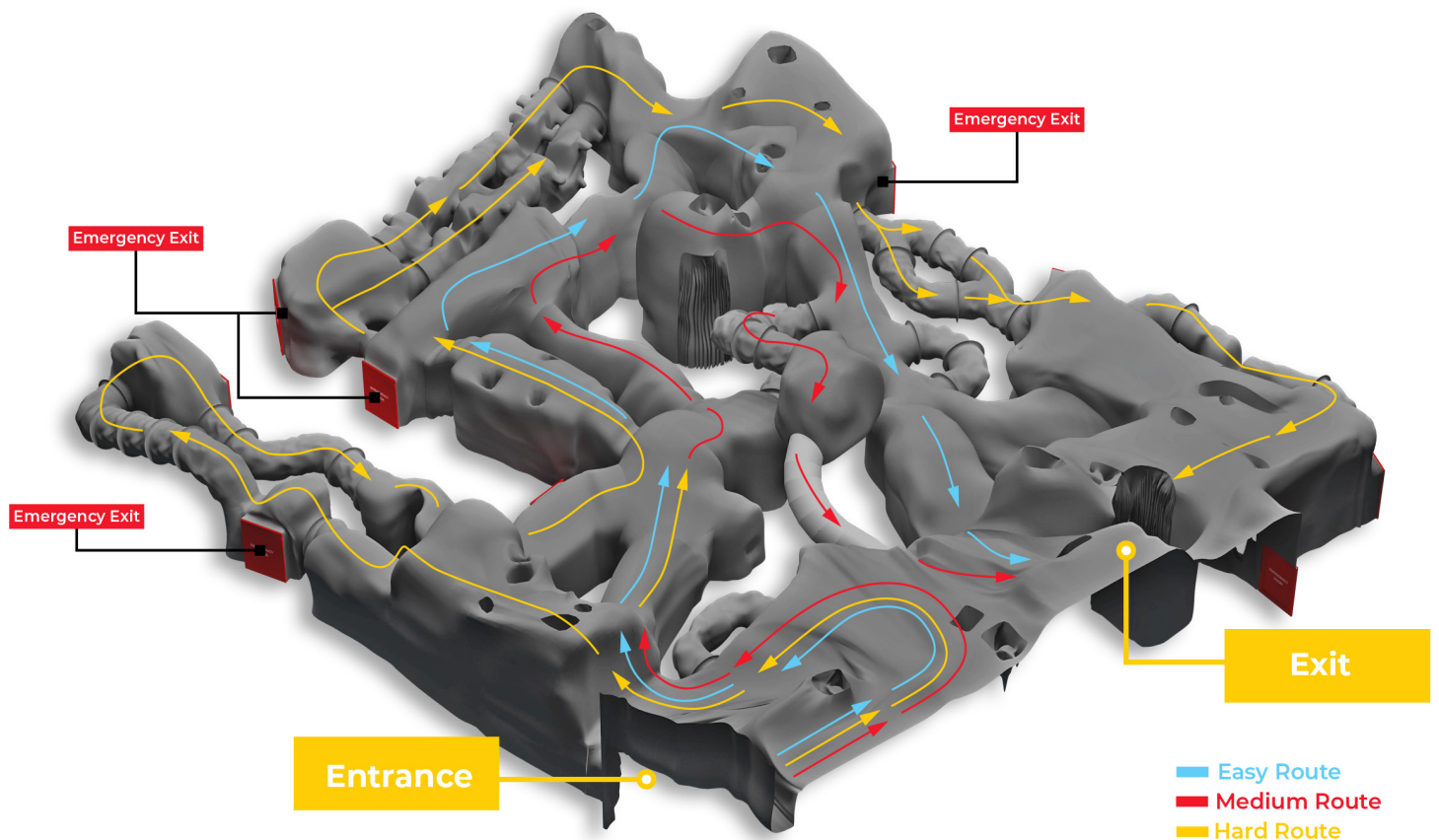

Momentum Capacity	120 people	
Footprint	520 m ²	5597.2 ft ²
Height	4,5 m	14.7 ft
Operational Length	234 m	767.7 ft
Routes	3	
Min. Operators Required	2	
GRP	1200 m ²	12,916 ft ²